











Product Spec. Sheet

Diamond Series- Dual Monitor Dual Swivel Wall Mount LCD Monitor Arm EM43114

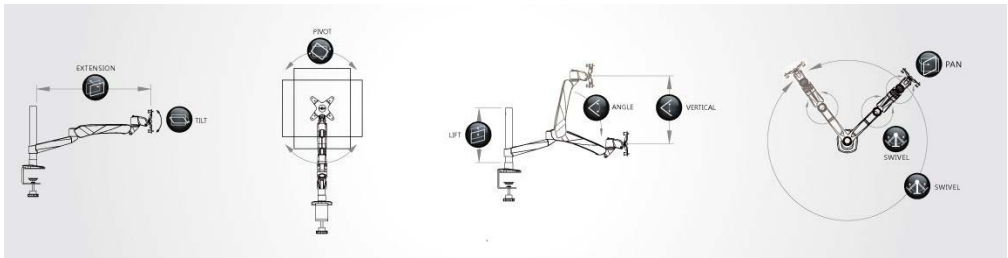
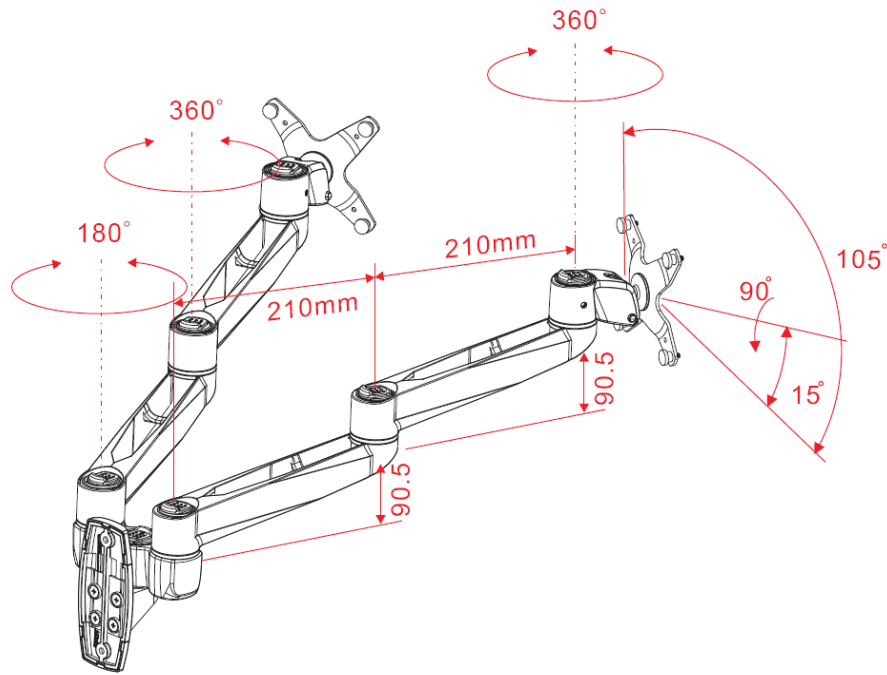

Product Name	Diamond Series Dual Monitor Dual Swivel Wall Mount LCD Monitor Arm
Model Number (color)	EM43114 (Silver Grey)
Product Includes	2 Dual Swivel Arm, Wall Mount Base Dual Stand, Monitor Bracketx2
Attachment Options	 Lock for Security
Product Dimension	White Box: L129*W256*H469MM N. W.: 4.3 KG
Units per Master Carton	4 Pcs
Shipping Master Carton Dimension	L526*W272*H486 mm
Shipping Weight	N.W.:17.2Kg G.W.:18.2Kg
Units per Pallet	128 Pcs
Warranty	14 Months
Weight Capacity	≤30Kg (66lbs) the max weight for single arm is ≤14Kg (30.8 lbs) almost any VESA compliant monitor up to 27"
Country of Origin	Taiwan

Features	<div><div>1. Elegant, Stylish and Ergonomic design with high performance</div><div>2. Wide Angle and height range for comfortable view position.</div><div>3. Swift Movement with easy adjustment.</div><div>4. 3 quick mode release function as Pivot stand, Swivel or Spring Arm.</div><div>5. Easily do install and dismount.</div><div>6. Aluminum alloy and metal material, strong and safety.</div><div>7. Internal cable management routed cables neatly under arm.</div><div>8. Space saving.</div><div>9. A considerate Tool fixed design, no more worrying tool of placement.</div><div>10. VESA MIS-D 75x75/100x100mm</div></div>
Tech Specs	<div><div><div><div><div>VESA</div></div><div><div>LIFT</div><div>---</div></div><div><div>ANGLE</div><div>---</div></div><div><div>PIVOT</div><div>360°</div></div><div><div>SWIVEL</div><div>180°</div></div><div><div>PAN</div><div>360°</div></div><div><div>TILT</div><div>105°</div></div><div><div>EXTENSIO</div><div>0-420mm</div></div><div><div>VERTICAL</div><div>---</div></div><div><div>Wt.Load</div><div>≤30Kg</div></div></div><div></div></div></div>
Drawing	<div><div>360°</div><div>360°</div><div>180°</div><div>210mm</div><div>210mm</div><div>90.5</div><div>90.5</div><div>360°</div><div>105°</div><div>90°</div><div>15°</div></div> <div>Untis : mm</div> <div>EM43114 Product line Drawing</div>

LCD ARM SYSTEM **USER'S MANUAL**

(螢幕支架使用手冊)

71H016135-015

1 Installation Method of Mount Type (夾座安裝方法)

A C-Clamp (C型夾)

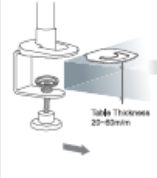

B Grommet (穿桌夾)

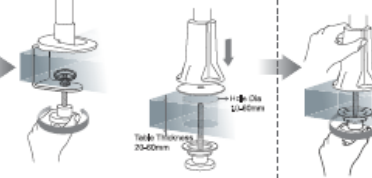

C Wall Mount (壁掛型)

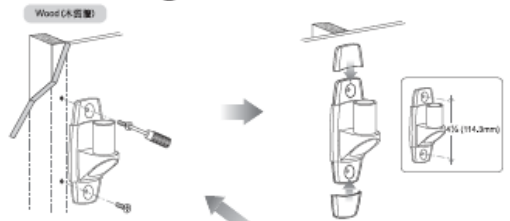

2 Install Arms (安裝支架)

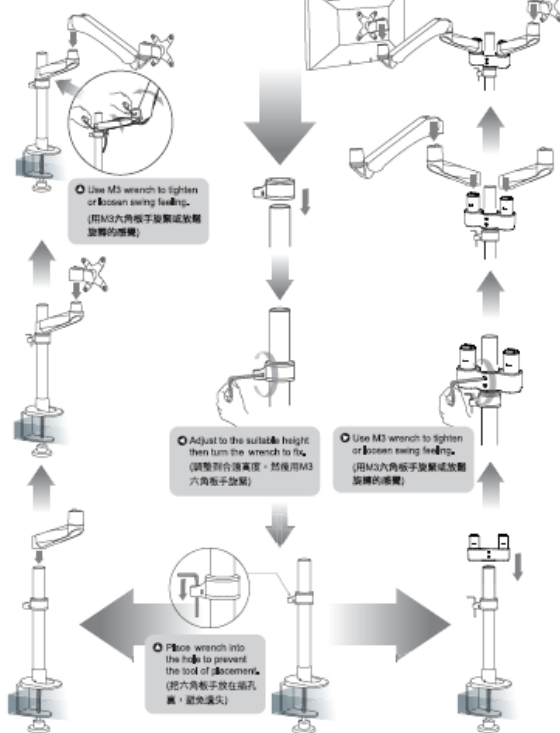

3 Install Monitors (安裝螢幕)

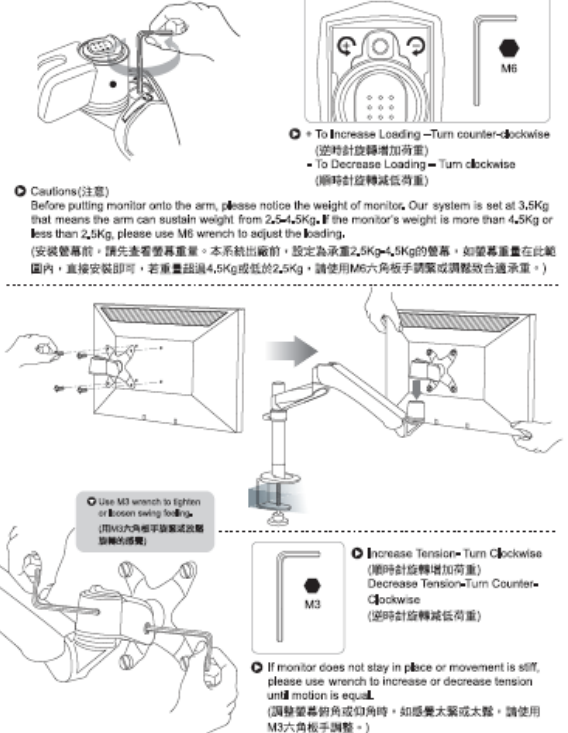











Route Cables (理線)

①

[illegible]

①

										
	VISA	LPT	ANGLE	PIST	SWIVEL	PAN	TILT	EXTENSION	VERTICAL	WE LOAD
EM31111	VP-0 (75x510x100)	200mm	0	360°	0	360°	105°	0	0	≤14kg
EM31116	VP-0 (75x510x100)	200mm	0	360°	0	360°	105°	0	0	≤14kg
EM31138	VP-0 (75x510x100)	200mm	0	360°	0	360°	105°	0	0	≤14kg
EM31114	VP-0 (75x510x100)	0	0	360°	0	180°	105°	0	0	≤14kg
EM32111	VP-0 (75x510x100)	200mm	0	360°	360°	360°	105°	210mm	0	≤14kg
EM32118	VP-0 (75x510x100)	200mm	0	360°	360°	360°	105°	210mm	0	≤14kg
EM32138	VP-0 (75x510x100)	200mm	0	360°	360°	360°	105°	210mm	0	≤14kg
EM32114	VP-0 (75x510x100)	0	0	360°	180°	360°	105°	210mm	0	≤14kg
EM33111	VP-0 (75x510x100)	200mm	0	360°	360°	360°	105°	420mm	0	≤14kg
EM33116	VP-0 (75x510x100)	200mm	0	360°	360°	360°	105°	420mm	0	≤14kg
EM33138	VP-0 (75x510x100)	200mm	0	360°	360°	360°	105°	420mm	0	≤14kg
EM33114	VP-0 (75x510x100)	0	0	360°	360°	360°	105°	420mm	0	≤14kg
EM34111	VP-0 (75x510x100)	200mm	100°	360°	360°	240°	105°	330mm	270mm	2-9kg
EM34116	VP-0 (75x510x100)	200mm	100°	360°	360°	240°	105°	330mm	270mm	2-9kg
EM34138	VP-0 (75x510x100)	200mm	100°	360°	360°	240°	105°	330mm	270mm	2-9kg
EM34114	VP-0 (75x510x100)	0	100°	360°	180°	240°	105°	330mm	270mm	2-9kg
EM34121	VP-0 (75x510x100)	0	100°	360°	360°	240°	105°	330mm	270mm	2-9kg
EM34126	VP-0 (75x510x100)	0	100°	360°	360°	240°	105°	330mm	270mm	2-9kg
EM34038	VP-0 (75x510x100)	0	100°	360°	360°	240°	105°	330mm	270mm	2-9kg
EM35111	VP-0 (75x510x100)	200mm	100°	360°	360°	240°	105°	540mm	270mm	2-9kg
EM35116	VP-0 (75x510x100)	200mm	100°	360°	360°	240°	105°	540mm	270mm	2-9kg
EM35138	VP-0 (75x510x100)	200mm	100°	360°	360°	240°	105°	540mm	270mm	2-9kg

1. 客戶滿意是我們努力追求的目標。為維持提供客戶最完善的售後服務及關於消費者的權利，請仔細閱讀說明書內的資訊。

1. 售戶滿意是我們努力追求的目標，為能持续提升我們完善的售後服務及關於消費者的權利，讓消費者買得明瞭內的資訊。
2. 為維護服務效率，將在維修保證及換貨時提供免費運費及保費。
3. 在購買貨品時，價格必須誠實買貨且並無欺詐，如經電腦證實，會變成在保固期內而無法免費維修。
4. 如經保固期間，消費者必須負擔零件及維修服務費。
5. 依據說明書內之規格使用，正常使用本產品，如使用會使用超額產品規格之承受重載，造成產品受損故障，是在保固期內，將不負免費維修或消費者必須負擔零件及維修服務費。

1. Consumer's satisfaction with our products is the goal that we have been heading for. To assume the best after-sale service to consumers and ensure consumer's rights, please read carefully the information stated in the instruction manual.
2. To enhance our service efficiency, please provide purchase invoice or warranty card if request for product maintenance or merchandise exchange.
3. The actual date of purchase and affixed used by distributor on warranty card is required. Free after-sale services will not be guaranteed even under warranty period should any incomplete purchase information.
4. The costs of components and maintenance will be at consumer's expense should the product is involved for warranty period.
5. Please refer to specification limitation specified in the instruction manual for correct usage. Even under the warranty period, this warranty does not extend the product or damage result from the misuse that exceeds the specification specified in the instruction manual and the costs of components and maintenance will be at consumer's expense.

Please lift arm up to highest position while removing the monitor. The monitor arm could bounce upward to cause personal injury when the weight of monitor is removed.

卸下螢幕時，請將支架移到最上端，因為維持平衡的螢幕重量被移開時，支架會反彈，可能會造成傷害。

