

# Product Spec. Sheet











## Diamond Series- 2-Joint Spring Arm

EM35111

Grommet Desk Mount LCD Monitor Arm

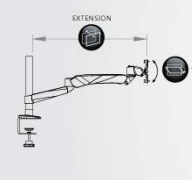
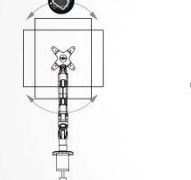
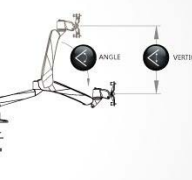
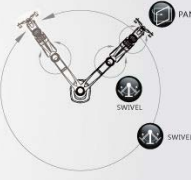
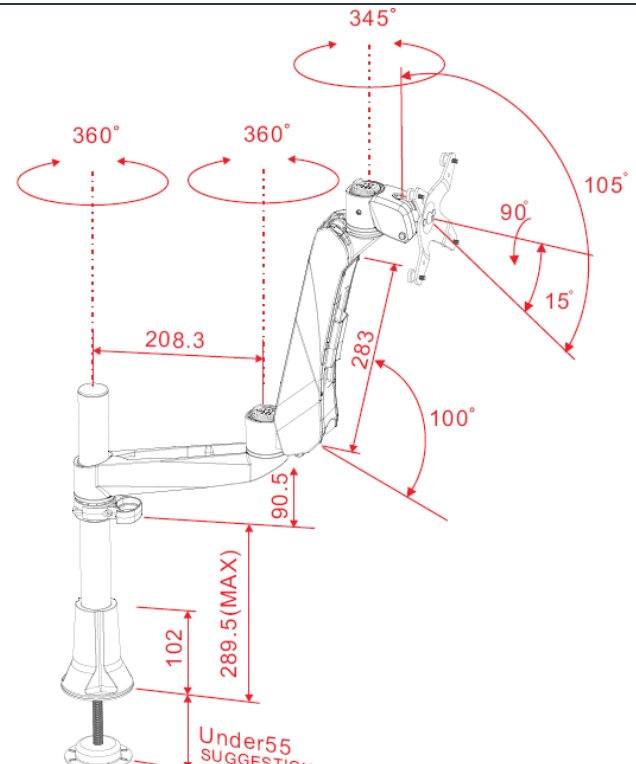

<b>Product Name</b>	Diamond Series Spring Arm
<b>Model Number (color)</b>	EM35111 (Silver Grey)
<b>Product Includes</b>	Spring Arm, extension Swivel Arm, Grommet desk Mount Base (Pole Length :302mm) Monitor Bracket
<b>Attachment Options</b>	 Lock for Security
<b>Product Dimens.</b>	Product : W120XH470XI280mm Weight : 3Kg Color Box : L290*W136*H462MM Weight : 3.7Kg
<b>Units per Master Carton</b>	5pcs
<b>Shipping Master Carton Dimens.</b>	Carton : L706*W475*H312MM
<b>Shipping Weight</b>	N.W.:18.5Kg G.W.:19.5Kg
<b>Units per Pallet</b>	90pcs
<b>Warranty</b>	14 Months
<b>Weight Capacity</b>	2Kg-9Kg (4.4-19.8lbs) almost any VESA compliant monitor up to 30"
<b>Country of Origin</b>	Taiwan

<b>Features</b>	<ol style="list-style-type: none"> <li>1. Elegant, Stylish and Ergonomic design with high performance</li> <li>2. Wide Angle and height range for comfortable view position.</li> <li>3. Swift Movement with easy adjustment.</li> <li>4. 3 quick mode release function as Pivot stand, Swivel or Spring Arm.</li> <li>5. Easily do install and dismount.</li> <li>6. Aluminum alloy and metal material, strong and safety.</li> <li>7. Internal cable management routed cables neatly under arm.</li> <li>8. Space saving.</li> <li>9. A considerate Tool fixed design, no more worrying tool of placement.</li> <li>10. VESA MIS-D 75x75/100x100mm</li> </ol>
<b>Tech Specs</b>	<div style="display: flex; justify-content: space-around; align-items: flex-end;"> <div style="text-align: center;">   VESA  0-200mm </div> <div style="text-align: center;">   LIFT  100° </div> <div style="text-align: center;">   ANGLE  360° </div> <div style="text-align: center;">   PIVOT  360° </div> <div style="text-align: center;">   SWIVEL  360° </div> <div style="text-align: center;">   PAN  240° </div> <div style="text-align: center;">   TILT  105° </div> <div style="text-align: center;">   EXTENSIO  0-540mm </div> <div style="text-align: center;">   VERTICAL  0-270mm </div> <div style="text-align: center;">   Wt.Load  2-9Kg </div> </div> <div style="display: flex; justify-content: space-around; margin-top: 10px;">     </div>
<b>Drawing</b>	



71H016135-015

## 1 Installation Method of Mount Type (夾座安裝方法)

### A C-Clamp (C型夾)

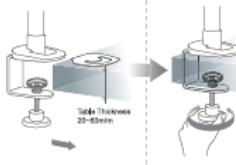

### B Grommet (穿桌夾)

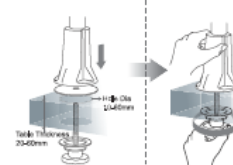

### C Wall Mount (壁掛型)

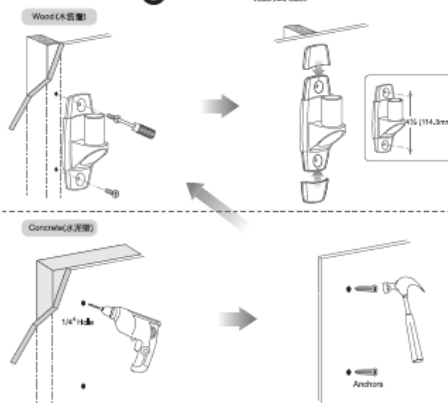

## 2 Install Arms (安裝支架)

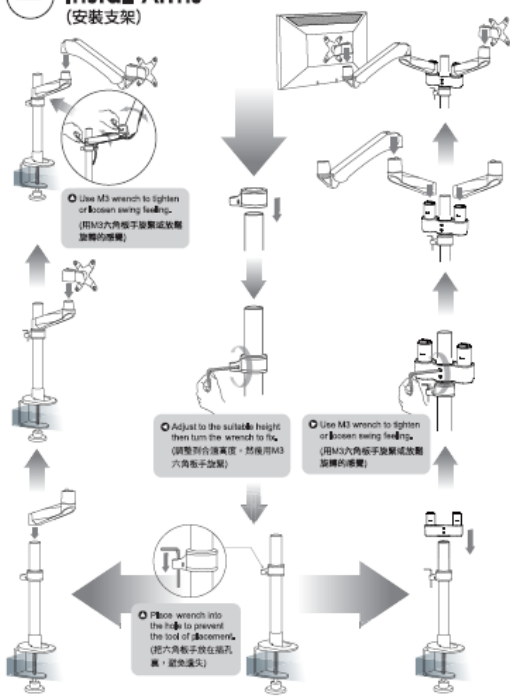

## 3 Install Monitors (安裝螢幕)

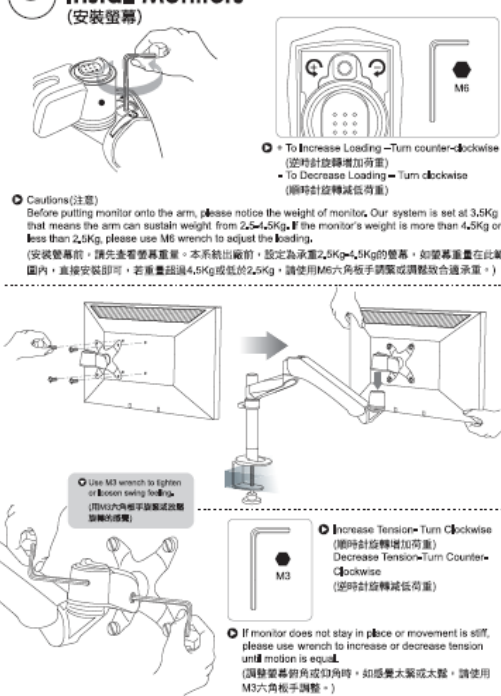











#### 4 Route Cables (理線)

④

[illegible]

①

										
	VESA (75x75/100/100)	LIFT (75x75/100/100)	ANGLE (75x75/100/100)	PIVOT (75x75/100/100)	SWIVEL (75x75/100/100)	PAN (75x75/100/100)	TILT (75x75/100/100)	EXTENSION (75x75/100/100)	VERTICAL (75x75/100/100)	W/Load (75x75/100/100)
EM35111	HB0 (75x75/100/100)	200mm	0	360°	0	360°	105°	0	0	≤14kg
EM35116	HB0 (75x75/100/100)	200mm	0	360°	0	360°	105°	0	0	≤14kg
EM35138	HB0 (75x75/100/100)	200mm	0	360°	0	360°	105°	0	0	≤14kg
EM35114	HB0 (75x75/100/100)	0	0	360°	0	180°	105°	0	0	≤14kg
EM35211	HB0 (75x75/100/100)	200mm	0	360°	360°	360°	105°	210mm	0	≤14kg
EM35216	HB0 (75x75/100/100)	200mm	0	360°	360°	360°	105°	210mm	0	≤14kg
EM35238	HB0 (75x75/100/100)	200mm	0	360°	360°	360°	105°	210mm	0	≤14kg
EM35214	HB0 (75x75/100/100)	0	0	360°	180°	360°	105°	210mm	0	≤14kg
EM35311	HB0 (75x75/100/100)	200mm	0	360°	360°	360°	105°	420mm	0	≤14kg
EM35316	HB0 (75x75/100/100)	200mm	0	360°	360°	360°	105°	420mm	0	≤14kg
EM35338	HB0 (75x75/100/100)	200mm	0	360°	360°	360°	105°	420mm	0	≤14kg
EM35314	HB0 (75x75/100/100)	0	0	360°	360° *	360°	105°	420mm	0	≤14kg
EM35411	HB0 (75x75/100/100)	200mm	105°	360°	360°	240°	105°	330mm	270mm	2~9kg
EM35416	HB0 (75x75/100/100)	200mm	105°	360°	360°	240°	105°	330mm	270mm	2~9kg
EM35438	HB0 (75x75/100/100)	200mm	105°	360°	360°	240°	105°	330mm	270mm	2~9kg
EM35414	HB0 (75x75/100/100)	0	105°	360°	180°	240°	105°	330mm	270mm	2~9kg
EM34121	HB0 (75x75/100/100)	0	105°	360°	360°	240°	105°	330mm	270mm	2~9kg
EM34128	HB0 (75x75/100/100)	0	105°	360°	360°	240°	105°	330mm	270mm	2~9kg
EM34038	HB0 (75x75/100/100)	0	105°	360°	360°	240°	105°	330mm	270mm	2~9kg
EM35511	HB0 (75x75/100/100)	200mm	105°	360°	360°	240°	105°	540mm	270mm	2~9kg
EM35516	HB0 (75x75/100/100)	200mm	105°	360°	360°	240°	105°	540mm	270mm	2~9kg
EM35538	HB0 (75x75/100/100)	200mm	105°	360°	360°	240°	105°	540mm	270mm	2~9kg
EM55111	HB0 (75x75/100/100)	330mm	0	360°	360°	360°	105°	210mm	0	≤14kg
EM55116	HB0 (75x75/100/100)	330mm	0	360°	360°	360°	105°	210mm	0	≤14kg
EM55138	HB0 (75x75/100/100)	330mm	0	360°	360°	360°	105°	210mm	0	≤14kg
EM55211	HB0 (75x75/100/100)	330mm	0	360°	360°	360°	105°	210mm	0	≤14kg
EM55216	HB0 (75x75/100/100)	330mm	0	360°	360°	360°	105°	210mm	0	≤14kg
EM55238	HB0 (75x75/100/100)	330mm	0	360°	360°	360°	105°	210mm	0	≤14kg

- \* 客戶滿意度是我們的宗旨，為快速解決客戶投訴及有關服務質素問題並及時對其作出賠償，特於此項保證書內列明各項資料。**
- \* 在處理客訴時，應以維護顧客利益為前提，竭誠提供優質售後保障及妥善賠償。**
- \* 如貴商所提之投訴與本合約條款有異，則以本合約為準。當遇到未預見或突發狀況時：**
- (一) 若因產品質量、性能等造成損失的，本公司將依照國家相關法律法規進行賠償；**
- (二) 對於非質量原因之意外損壞情況，正常使用下發生且經查明屬實者除外，或因不當操作所致，應在扣除保用金外，視不同具體情形酌量給予減價折扣及其他合理賠款。**
- \* Consumer's satisfaction with our products is the goal that we have been heading for. To ensure the best after-sale service to consumers and protect consumer's rights, please read carefully the following contents specified in the instruction manual.**
- \* To enhance our service efficiency, please provide purchase invoice or warranty card if requested for product maintenance or merchandise exchange.**
- \* The actual date of purchase and affected used by distributor on warranty card is required. Free after-sale service will not be guaranteed even under warranty period without complete purchase information.**
- \* The costs of components and maintenance will be at customer's expense should the product is influenced severely for warranty period.**
- \* Please refer to specification Instruction specified in the instruction manual for correct usage. Even under the warranty period, this warrant does not cover the problems or damage resulting from the loading weight that exceeds the specification specified in the Instruction Manual.**

Please lift arm up to highest position while removing the monitor. The monitor arm could bounce upward to cause personal injury when the weight of monitor is removed.

卸下螢幕時，請將支架移到最上端，因為維持平衡的螢幕重量被移開時，支架會反彈，可能會造成傷害。

