

Product Spec. Sheet

Diamond Series- 2-Joint Spring Arm













EM35114

Wall Mount LCD Monitor Arm

Quick Install & Dismount

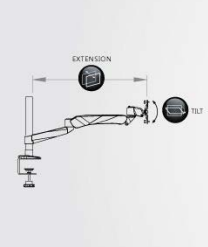
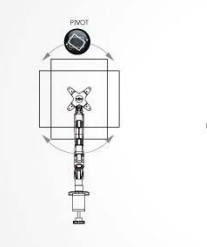
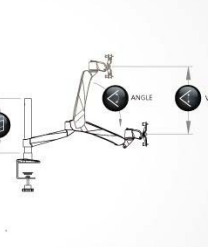

Product Name	Diamond Series Spring Arm
Model Number (color)	EM35114 (Silver Grey)
Product Includes	Spring Arm, extension Swivel Arm, Wall Mount Base, Monitor Bracket
Attachment Options	 Lock for Security
Product Dimens.	Product : W120XH430XD270mm Weight : 2.5Kg Color Box : L178*W139*H429mm Weight : 3.1Kg
Units per Master Carton	6pcs
Shipping Master Carton Dimens.	Carton : L442*W438*H386mm
Shipping Weight	N.W.:18.6Kg G.W.:19.6Kg
Units per Pallet	120pcs
Warranty	14 Months
Weight Capacity	2Kg-9Kg (4.4-19.8lbs) almost any VESA compliant monitor up to 30"
Country of Origin	Taiwan

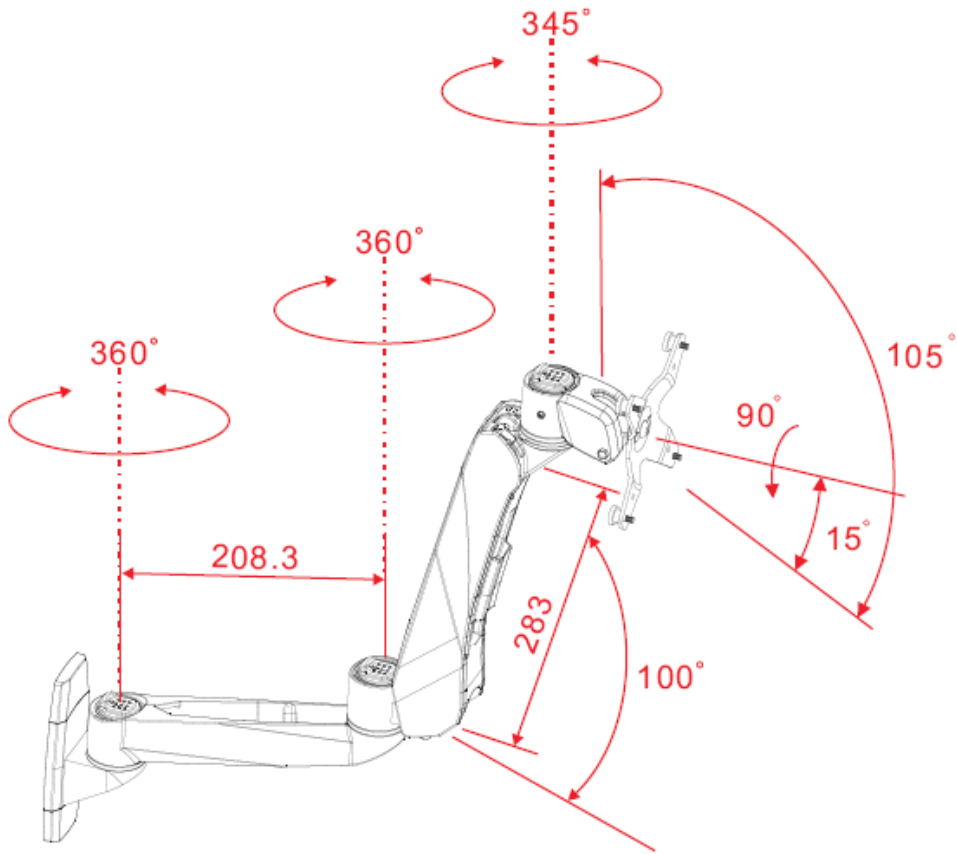
Features	<ol style="list-style-type: none"> 1. Elegant, Stylish and Ergonomic design with high performance 2. Wide Angle and height range for comfortable view position. 3. Swift Movement with easy adjustment. 4. 3 quick mode release function as Pivot stand, Swivel or Spring Arm. 5. Easily do install and dismount. 6. Aluminum alloy and metal material, strong and safety. 7. Internal cable management routed cables neatly under arm. 8. Space saving. 9. A considerate Tool fixed design, no more worrying tool of placement. 10. VESA MIS-D 75x75/100x100mm
Tech Specs	<div style="display: flex; justify-content: space-around; align-items: flex-end;"> <div style="text-align: center;">  VESA 0 </div> <div style="text-align: center;">  LIFT 0 </div> <div style="text-align: center;">  ANGLE 100° </div> <div style="text-align: center;">  PIVOT 360° </div> <div style="text-align: center;">  SWIVEL 180° </div> <div style="text-align: center;">  PAN 240° </div> <div style="text-align: center;">  TILT 105° </div> <div style="text-align: center;">  EXTENSIO 0-540mm </div> <div style="text-align: center;">  VERTICAL 0-270mm </div> <div style="text-align: center;">  Wt.Load 2-9Kg </div> </div> <div style="display: flex; justify-content: space-around; margin-top: 10px;">     </div>
Drawing	



71H016135-015

1 Installation Method of Mount Type (夾座安裝方法)

A C-Clamp (C型夾)

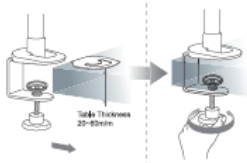

B Grommet (穿桌夾)

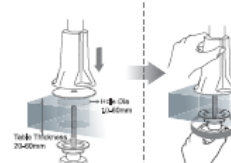

C Wall Mount (壁掛型)

Wood (木質牆)

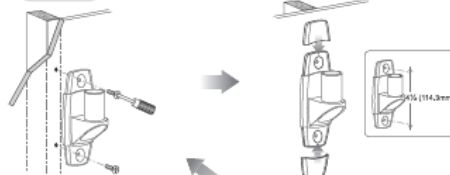

Concrete (水泥牆)

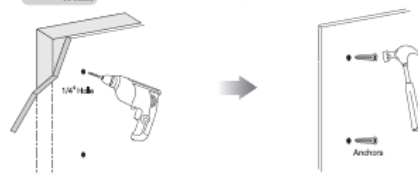

2 Install Arms (安裝支架)

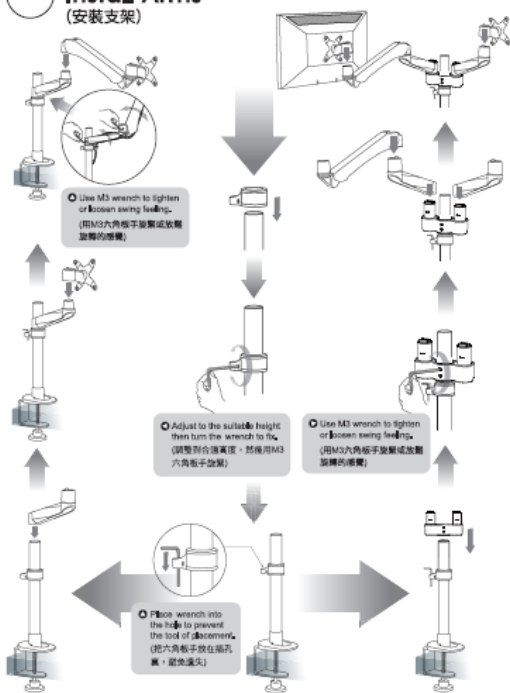

3 Install Monitors (安裝螢幕)

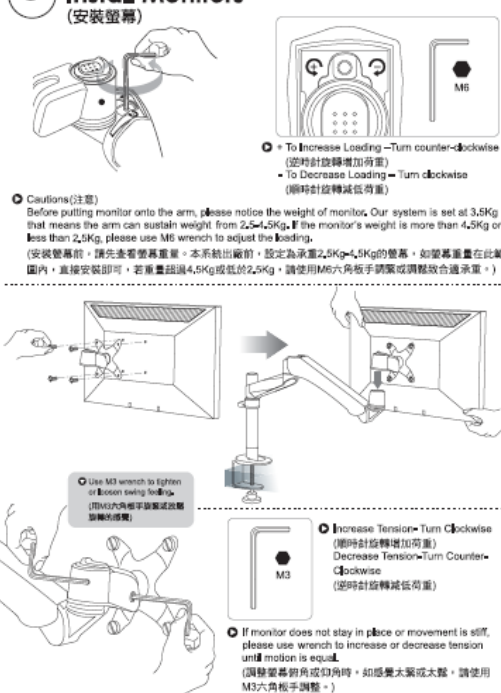











4 Route Cables (理線)

④

[illegible]

①

										
	VESA (75x75/100/100)	LIFT (75x75/100/100)	ANGLE (75x75/100/100)	PIVOT (75x75/100/100)	SWIVEL (75x75/100/100)	PAN (75x75/100/100)	TILT (75x75/100/100)	EXTENSION (75x75/100/100)	VERTICAL (75x75/100/100)	W/Load (75x75/100/100)
EM35111	HB0 (75x75/100/100)	200mm	0	360°	0	360°	105°	0	0	≤14kg
EM35116	HB0 (75x75/100/100)	200mm	0	360°	0	360°	105°	0	0	≤14kg
EM35138	HB0 (75x75/100/100)	200mm	0	360°	0	360°	105°	0	0	≤14kg
EM35114	HB0 (75x75/100/100)	0	0	360°	0	180°	105°	0	0	≤14kg
EM35211	HB0 (75x75/100/100)	200mm	0	360°	360°	360°	105°	210mm	0	≤14kg
EM35216	HB0 (75x75/100/100)	200mm	0	360°	360°	360°	105°	210mm	0	≤14kg
EM35238	HB0 (75x75/100/100)	200mm	0	360°	360°	360°	105°	210mm	0	≤14kg
EM35214	HB0 (75x75/100/100)	0	0	360°	180°	360°	105°	210mm	0	≤14kg
EM35311	HB0 (75x75/100/100)	200mm	0	360°	360°	360°	105°	420mm	0	≤14kg
EM35316	HB0 (75x75/100/100)	200mm	0	360°	360°	360°	105°	420mm	0	≤14kg
EM35338	HB0 (75x75/100/100)	200mm	0	360°	360°	360°	105°	420mm	0	≤14kg
EM35314	HB0 (75x75/100/100)	0	0	360°	360° *	360°	105°	420mm	0	≤14kg
EM35411	HB0 (75x75/100/100)	200mm	105°	360°	360°	240°	105°	330mm	270mm	2~9kg
EM35416	HB0 (75x75/100/100)	200mm	105°	360°	360°	240°	105°	330mm	270mm	2~9kg
EM35438	HB0 (75x75/100/100)	200mm	105°	360°	360°	240°	105°	330mm	270mm	2~9kg
EM35414	HB0 (75x75/100/100)	0	105°	360°	180°	240°	105°	330mm	270mm	2~9kg
EM34121	HB0 (75x75/100/100)	0	105°	360°	360°	240°	105°	330mm	270mm	2~9kg
EM35428	HB0 (75x75/100/100)	0	105°	360°	360°	240°	105°	330mm	270mm	2~9kg
EM35038	HB0 (75x75/100/100)	0	105°	360°	360°	240°	105°	330mm	270mm	2~9kg
EM35311	HB0 (75x75/100/100)	200mm	105°	360°	360°	240°	105°	540mm	270mm	2~9kg
EM35316	HB0 (75x75/100/100)	200mm	105°	360°	360°	240°	105°	540mm	270mm	2~9kg
EM35338	HB0 (75x75/100/100)	200mm	105°	360°	360°	240°	105°	540mm	270mm	2~9kg
EM35314	HB0 (75x75/100/100)	200mm	105°	360°	360°	240°	105°	540mm	270mm	2~9kg
EM35216	HB0 (75x75/100/100)	330mm	0	360°	360°	360°	105°	420mm	0	≤14kg
EM35238	HB0 (75x75/100/100)	330mm	0	360°	360°	360°	105°	420mm	0	≤14kg
EM35214	HB0 (75x75/100/100)	330mm	0	360°	360°	360°	105°	420mm	0	≤14kg
EM45111	HB0 (75x75/100/100)	160mm	105°	360°	360°	360°	105°	540mm	270mm	≤20kg
EM45116	HB0 (75x75/100/100)	160mm	105°	360°	360°	360°	105°	540mm	270mm	≤20kg
EM45138	HB0 (75x75/100/100)	160mm	105°	360°	360° *	240°	105°	540mm	270mm	≤20kg
EM45114	HB0 (75x75/100/100)	0	105°	360°	360°	240°	105°	540mm	270mm	≤20kg
EM45121	HB0 (75x75/100/100)	0	105°	360°	360°	240°	105°	540mm	270mm	Each Arm ≤5kg
EM45126	HB0 (75x75/100/100)	0	105°	360°	360°	240°	105°	540mm	270mm	Each Arm ≤5kg
EM45038	HB0 (75x75/100/100)	0	105°	360°	360°	240°	105°	540mm	270mm	Each Arm ≤5kg
EM52111	HB0 (75x75/100/100)	350mm	0	360°	360°	360°	105°	210mm	0	≤14kg ≤20kg
EM55111	HB0 (75x75/100/100)	330mm	105°	360°	360°	360°	240°	105°	540mm	≤20kg 270mm
EM55116	HB0 (75x75/100/100)	330mm	105°	360°	360°	360°	240°	105°	540mm	≤20kg 270mm
EM55138	HB0 (75x75/100/100)	330mm	105°	360°	360°	360°	240°	105°	540mm	≤20kg 270mm
EM55311	HB0 (75x75/100/100)	330mm	0	360°	360°	360°	105°	420mm	0	≤14kg ≤20kg
EM55316	HB0 (75x75/100/100)	330mm	0	360°	360°	360°	105°	420mm	0	≤14kg ≤20kg
EM55338	HB0 (75x75/100/100)	330mm	0	360°	360°	360°	105°	420mm	0	≤14kg ≤20kg

1. 客戶滿意度是本公司致力追求目標，為協助提升客戶滿意度，特將本服務條款及其附件列明於內，請於收到貨品後即向本公司索取。
2. 本服務條款僅適用於本公司所售之貨品，並不適用於本公司之服務。
3. 在買貨時，請細閱本服務條款及相關附件，如有不清楚之處，請向本公司之售貨員或客戶服務人員查詢。
4. 本公司之售貨員，應向貴客清楚說明本服務條款之內容。
5. 當貴客收到貨品時，請細閱本服務條款，正當使用本公司貨品，即視同貴客已接受本服務條款之內容，並同意受其約束。若貴客在收到貨品時，不滿意貴客所購買之貨品，請向本公司索取退換貨。
6. Consumer's satisfaction with our products is the goal that we have been heading for. To ensure the best after-sale service to consumers and to enhance our service efficiency, please provide purchase invoice or warranty card if required for product maintenance or merchandise exchange.
7. The actual date of purchase and offered used by distributor on warranty card is required. Free after-sale service will not be guaranteed even under warranty period, should you purchase informatics.
8. The costs of components and maintenance will be at consumer's expense should the product is in-fault for warranty period.
9. Please refer to specification/limitation specified in the instruction manual for correct access. Even under the warranty period, this warrant does not cover the problems or damage resulting from the loading method that exceeds the specification specified in the instruction manual.

Please lift arm up to highest position while removing the monitor. The monitor arm could bounce upward to cause personal injury when the weight of monitor is removed.

卸下螢幕時，請將支架移到最上端，因為維持平衡的螢幕重量被移開時，支架會反彈，可能會造成傷害。

